

AVAILABLE

Contemporary Space Center City, Philadelphia



2210 Walnut Street • Philadelphia, PA

- Two (2) story building containing a total of approximately 4,382 square feet.
- Zoned RMX-3 permitting retail, office and commercial uses.
- Excellent visibility and exposure on Walnut Street.
- Close proximity to Rittenhouse Square, Central Business District and University City.
- Walking distance to 30th Street Station, Drexel University and University of Pennsylvania campuses.
- Neighboring tenants include Rite Aid, Sunoco, Sweat Fitness, Vernick Food & Drink, The Irish Pub, Saxby's Coffee and Carlo's Bake Shop.

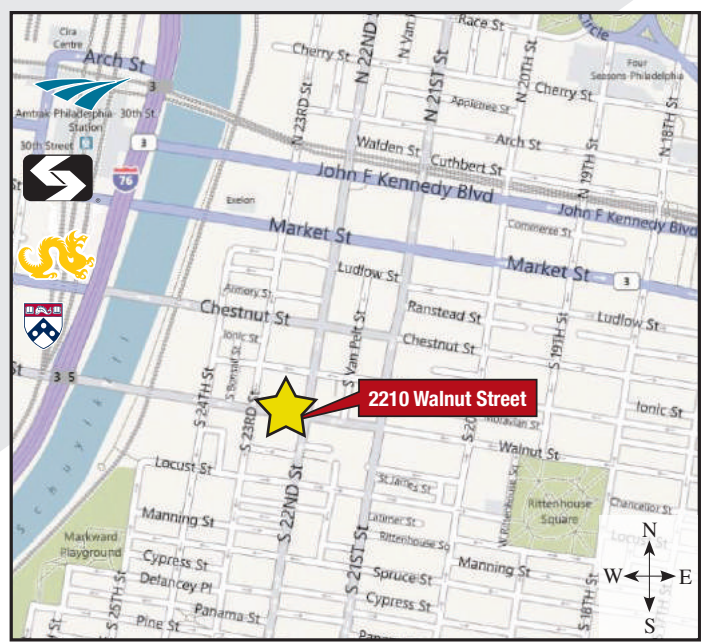

*Map not to scale

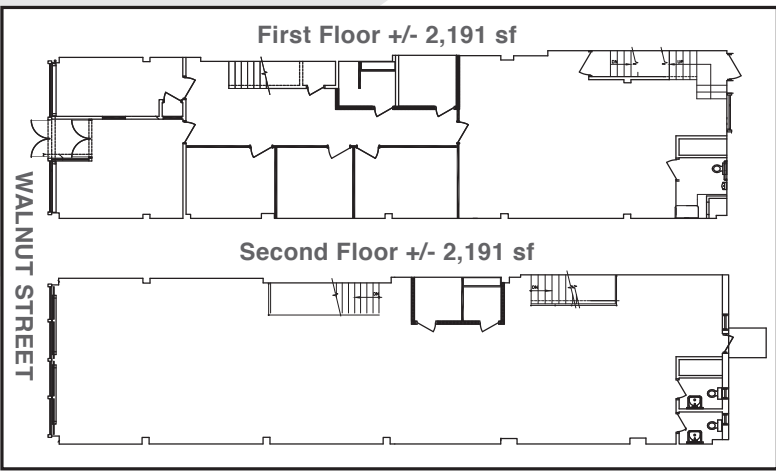

Commercial Real Estate Services

275 Commerce Drive • Suite 104
Fort Washington, PA 19034

215-886-9400
www.situsproperties.com

The foregoing information was furnished to us by sources which we deem to be reliable, but no warranty or representation is made as to the accuracy thereof. Subject to correction of errors, omissions, change of price, prior sale or withdrawal from market without notice.