

PRIME RETAIL AND OFFICE SPACE

Willow Grove Square

31-49 Easton Road | Willow Grove | PA



Commercial
Real Estate
Services

PROPERTY HIGHLIGHTS

- Shopping center with approximately 10,275 square feet of second floor office space and 15,509 square feet of retail stores anchored by Wells Fargo Bank.
- Ample parking for eighty (80) cars.
- Conveniently located one (1) block from the Willow Grove Park Mall.
- Minutes from from the Willow Grove Interchange of the PA Turnpike providing access throughout the Philadelphia Metropolitan area.
- Walking distance to the SEPTA Willow Grove Train Station and SEPTA commuter bus service with stops on Easton and Old York Roads.
- Nearby retailers include Aldi, AAA, Dick's Sporting Goods, At Home, Five Below, Marshall's, Giant, Wawa and Amazon Fresh.
- Adjacent to multi-phased, multi- million dollar redevelopment of Willow Grove Shopping Center featuring new retail concepts and 204 residential units.

DEMOGRAPHICS	1 MILE RADIUS	3 MILE RADIUS	5 MILE RADIUS
Population	17,332	91,439	241,785
Households	6,600	35,615	93,977
Average HH Income	\$109,325	\$127,529	\$130,463

The foregoing information was furnished to us by sources which we deem to be reliable, but no warranty or representation is made as to the accuracy thereof. Subject to correction of errors, omissions, change of price, prior sale or withdrawal from market without notice.



SitusProperties.com
215-886-9400

PRIME RETAIL AND OFFICE SPACE

Willow Grove Square

31-49 Easton Road | Willow Grove | PA

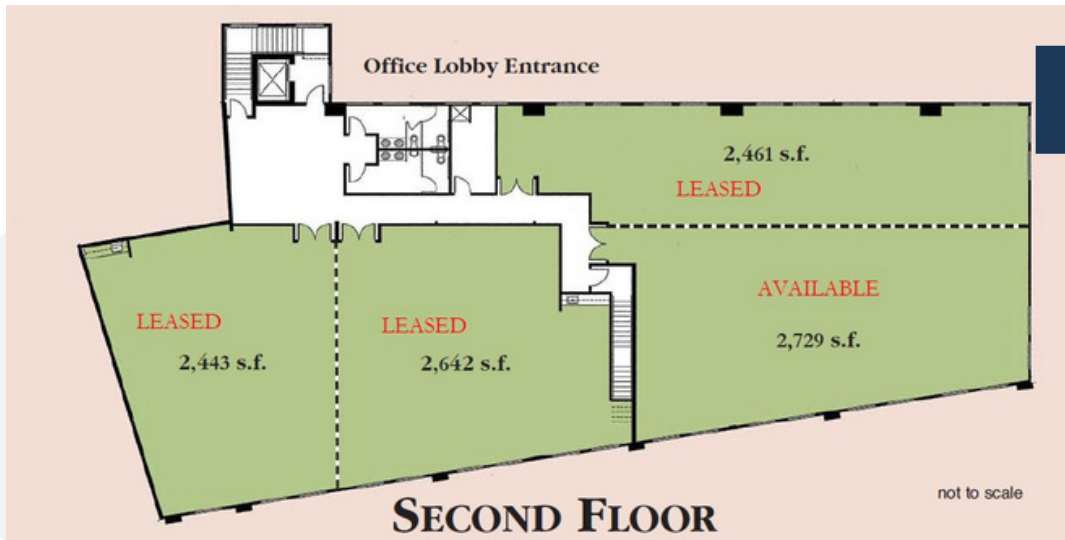

Commercial Real Estate Services

SitusProperties.com
215-886-9400

The foregoing information was furnished to us by sources which we deem to be reliable, but no warranty or representation is made as to the accuracy thereof. Subject to correction of errors, omissions, change of price, prior sale or withdrawal from market without notice.

Willow Grove Square

31-49 Easton Road | Willow Grove | PA

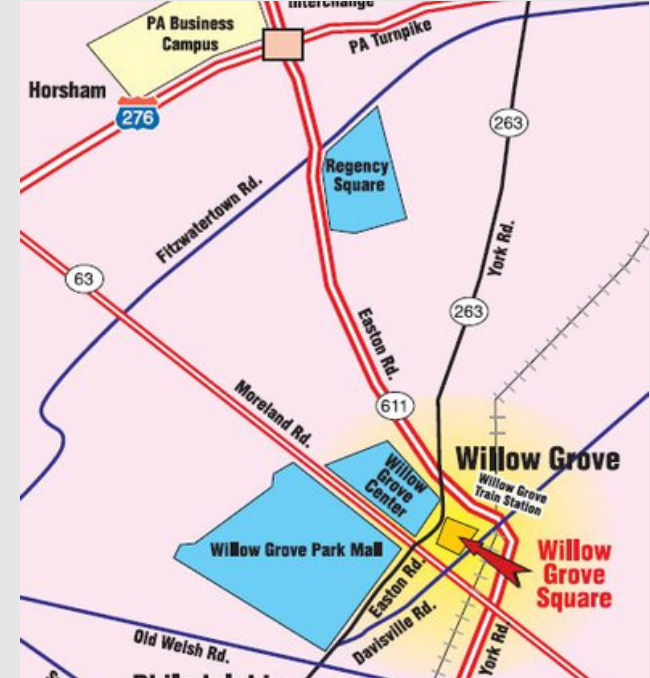

Commercial Real Estate Services