

AVAILABLE

Prime Retail Space



The Shoppes at Blueberry Hill • 1723 South Easton Road • Doylestown, PA

- Available retail space of approximately 2,400 square feet with two (2) drive-thru lanes.
- Parking for 23 cars.
- Pylon signage available.
- Average daily traffic count of 35,140 vehicles that pass the site on Easton Road (Rt. 611).
- Adjacent to 400,000 square feet of retail shopping and restaurants anchored by Kohl's, Redner's Warehouse Markets, Marshalls, and Sears.
- Located at the highly visible intersection of Easton Road (Rt. 611) and Almshouse Road just minutes from Doylestown Borough.



Map not to scale



Commercial Real Estate Services

275 Commerce Drive • Suite 104
Fort Washington, PA 19034

215-886-9400

www.situsproperties.com

The foregoing information was furnished to us by sources which we deem to be reliable, but no warranty or representation is made as to the accuracy thereof. Subject to correction of errors, omissions, change of price, prior sale or withdrawal from market without notice.

**The Shoppes at Blueberry Hill
1723 South Easton Road
Doylestown, PA**

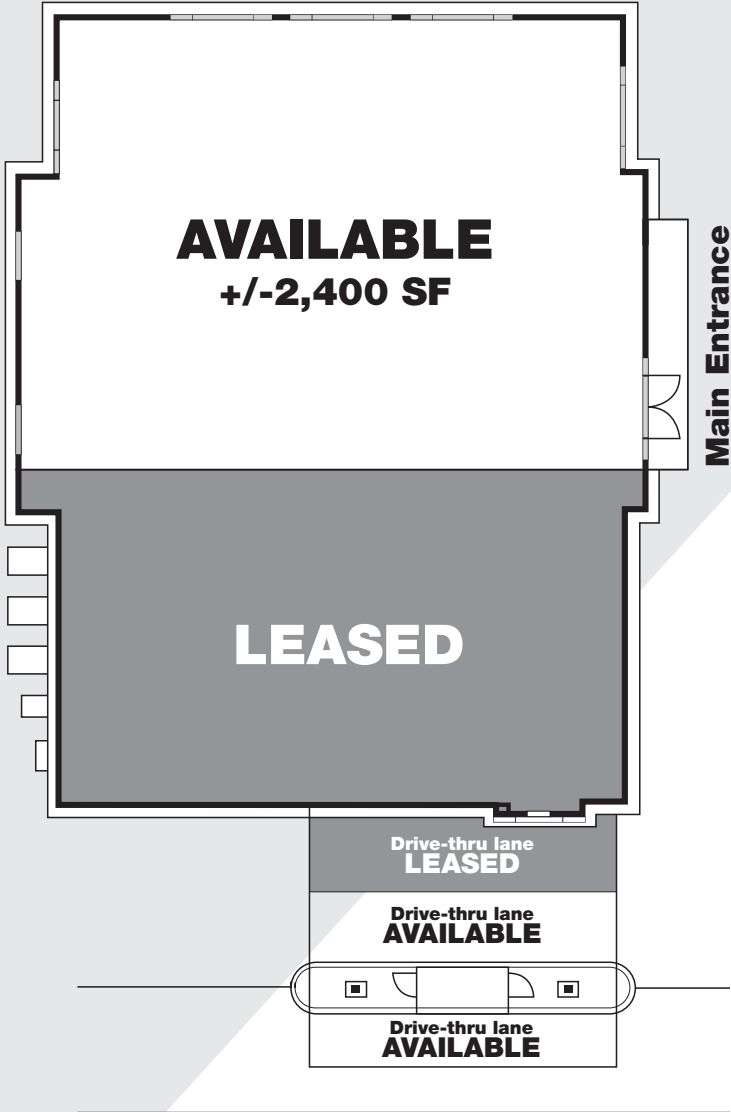

Commercial Real Estate Services

275 Commerce Drive • Suite 104
Fort Washington, PA 19034

215-886-9400

www.situsproperties.com

The foregoing information was furnished to us by sources which we deem to be reliable, but no warranty or representation is made as to the accuracy thereof. Subject to correction of errors, omissions, change of price, prior sale or withdrawal from market without notice.