

PROFESSIONAL OFFICE SPACE

801 Bethlehem Pike | Erdenheim | PA

LEASE



PROPERTY HIGHLIGHTS

- First floor office space plus basement consisting of 2,459 +/- square feet.
- Move-in condition for immediate occupancy.
- Private tenant entrance, bathrooms and kitchenette.
- Ample parking.
- Accessible throughout the Philadelphia metropolitan area via the Pennsylvania Turnpike (I-276) Fort Washington Interchange, Route 309, and Route 611.

Excellent visibility and prominent signage on Bethlehem Pike



**Commercial
Real Estate
Services**

Self-contained environment allowing for limited contact and maximum privacy.

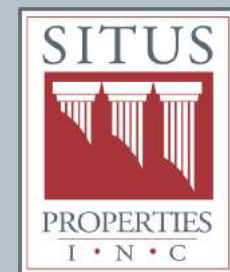

SitusProperties.com
215-886-9400

PROFESSIONAL OFFICE SPACE

801 Bethlehem Pike | Erdenheim | PA

**Commercial
Real Estate
Services**

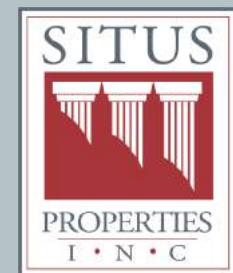
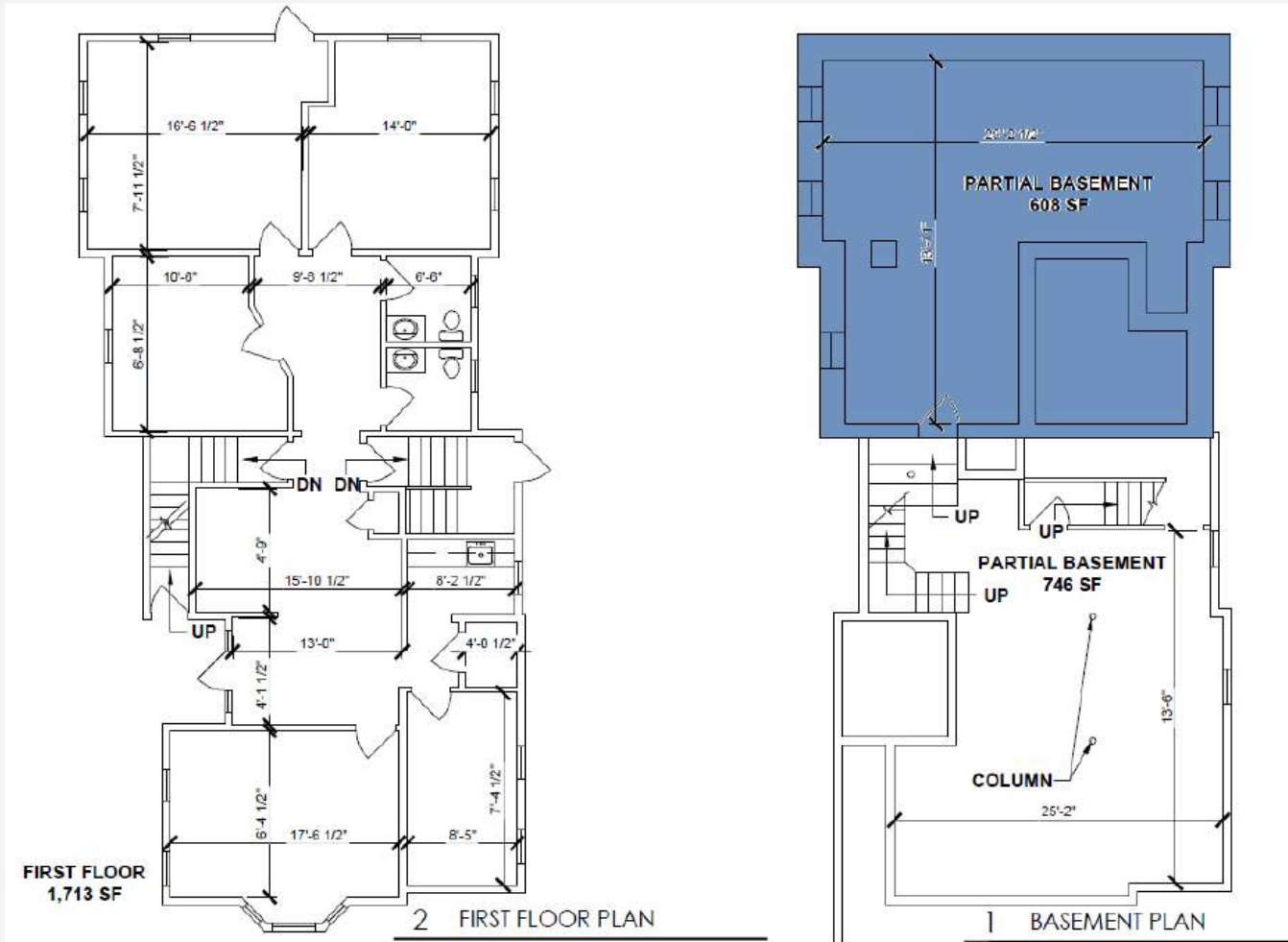

**SitusProperties.com
215-886-9400**

The foregoing information was furnished to us by sources which we deem to be reliable, but no warranty or representation is made as to the accuracy thereof. Subject to correction of errors, omissions, change of price, prior sale or withdrawal from market without notice.

PROFESSIONAL OFFICE SPACE

801 Bethlehem Pike | Erdenheim | PA

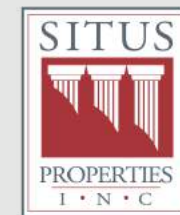

Commercial Real Estate Services

The foregoing information was furnished to us by sources which we deem to be reliable, but no warranty or representation is made as to the accuracy thereof. Subject to correction of errors, omissions, change of price, prior sale or withdrawal from market without notice.

SitusProperties.com
215-886-9400